



EL-4SP-10W-SMARTRGB-FR

4" LED SLIM PANEL with FIRE RATED FIXTURE & DRIVER

Eliteline



EL-4SP-10W-SMARTRGB-FR

4" 10W RGB Slim Panel with Fire Rated Fixture & Driver
1000 Lumens

RGB + 3000K-6000K

Features

Smart Control

1. Cell-phone and voice-intelligent controlled home lighting, with scene-optional choices for changing the temperature and luminance of light through an APP on your mobile device. There are 16 million variations of color that you can choose from.
2. Cell-phone Control: Open the remote control APP, and enjoy a new lifestyle instead of "get up to turn off lights" or "forget to turn off lights".
3. Voiced Control: Says "turn the light pink in dining-room" to Google Home, then you can enjoy a romantic environment. The product is supported by mainstream smart home platform, such as Amazon Echo, Google Home, etc.
4. On/off, timing, brightness adjustment, mode selection, and color switching.
5. Wireless module connection, safe and reliable, ultra-low power consumption.
6. Built-in global cloud service, extremely reliable system deployment architecture with uninterrupted continuous service.
7. Top level information security, ISO 27001 information security management system certification.

LED Characteristics

This general application light fixture features a 10 watt LED module that maintains uniform intensity producing 1000 lumens; with a typical CRI of 80+. Available in RGB + 3000K-6000K colour temperature.

Dimming

5%-100% dimming capability. This fixture is compatible with APP.

Body

2 hours fire rated body with etched white polycarbonate diffuser lens for low glare. Heat Resistant Steel Casing Provides up to 2 Hour Fire Protection. 2 layers Type x (or Type C) gypsum.

Beam Spread

The fixture lens provides 100° beam spread.

Mounting

Includes two spring loaded clips to attached to any ceiling material. The slim profile allows to be mounted under joists or duct work.

LED Driver

Extruded junction box with 210mA dimmable class II electronic LED driver with 120V 60Hz input.

Quick Connect push-in terminals

Three "Quick connect" push-in terminals for fast and easy wiring.

Operating Temperature

-20°C ~ 40°C (-4°F ~ 104°F)

Environment

Suitable for damp locations.
Suitable for insulated ceiling applications.

Certificate

This LED recessed light is IC rated, ETL ES certified and wire terminal is UL-certified. It is permitted to be in contact with insulations in ceilings, meaning the junction box is thermally protected.

Requirement

Internet connection with a WIFI network
Strong WIFI signal
2.4G Hz wireless frequency
Password protected WIFI network for security reason
Router with sufficient connections

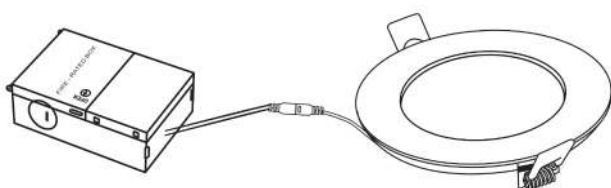

Description

The ultra-thin recessed light is a 10 watt 4" slim profile light fixture for recessed retrofit application. It is a high-performance, easy to install residential grade downlight solution that offers good light output, energy efficiency and streamlined design. Suitable for damp locations.

See reverse side for more instructions
Voir au verso pour plus d'instructions

Eliteline



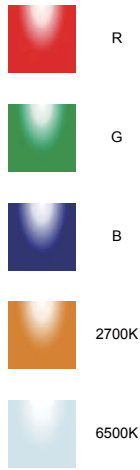

PRODUCT SPECIFICATIONS

Product	EL-4SP-10W-SMARTRGB-FR
Type	4"
Power	10W
Voltage - Frequency	120VAC 60Hz
Color Temp. (ANSI)	RGB+3000K~6000K
CRI (Ra)	>80
Typical lumens (lm)	1000
Efficacy (LPW)	100
Beam Angle	100°
Dimmable	Yes
Power Factor	0.9
Operating Temperature	-20°C~40°C (-4°F~104°F)

Installation



Use tools to open the appropriate holes in the ceiling.

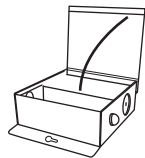

Open the box
Take out accessory of wire clip.

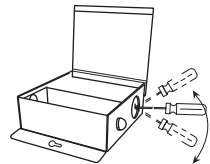

Use suitable tool to remove one of the knockouts of the side plate.

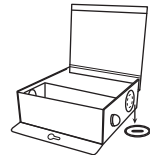

Remove one of the knockouts on the side plate.
Put wires through the hole.

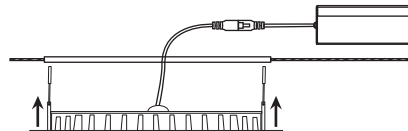
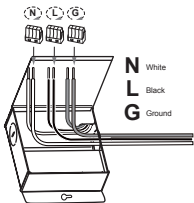

Holding the clips, and push the fixture into installation hole.

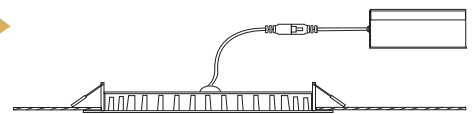

Release spring clips and push into place.

See reverse side for more instructions
Voir au verso pour plus d'instructions

Eliteline

